

∴ Camera settings for photographic documentation with the HEINE DELTA® 20 T/HEINE DELTA® 20 PLUS/DELTA® 20 Dermatoscope and HEINE SLR Photo adaptor

Digital high-resolution photography is the method of choice for optimum image documentation in dermatology. Through observation and documentation, early biopsy can be avoided, and benign lesions can be checked and monitored over time. Digital images allow the doctor and patient to discuss a diagnosis and the accurate therapy together. The combination of the DELTA® 20 T/DELTA® 20 Plus/DELTA® 20 and a digital SLR camera allows for consistent high quality photographs.

This step-by-step guide will show you how to connect a DELTA® 20 T/DELTA® 20 Plus/DELTA® 20 to a Digital SLR camera, and which settings are optimal for your camera. For proper use please read the DELTA® 20 T/DELTA® 20 Plus/DELTA® 20 user manual carefully.

1. The following current digital SLR cameras are recommended in connection with the DELTA® 20 T/DELTA® 20 Plus/DELTA® 20.

Manufacturer	Type	HEINE SLR Photo Adaptor
Canon	EOS 7D Mark II	K-000.34.185
	EOS 60D / 80D	
	EOS 100D / 700D	
	EOS 750D / 760D / 1300D	
Nikon	D500 / D3200 / D3300	K-000.34.186
	D3400 / D5200 / D5300	
	D5500 / D7100 / D7200	

Other currently available models from Canon and Nikon are not supported or deliver photographic material of insufficient quality. The current Olympus camera portfolio is not compatible any more with HEINE SLR adaptors. Some of the older Canon, Nikon or Olympus models are compatible with the SLR adaptor. If you wish to use an older camera, please contact marketing@heine.com to get the compatibility checked.

2. For best results, please assemble the following components: DELTA® 20 T/DELTA® 20 Plus/DELTA® 20 Dermatoscope ① with contact plate and scale, BETA handle ② as power source, HEINE Photo Accessory Set consisting of HEINE SLR Photo adaptor ④ (Canon, Nikon or Olympus) adaptor cord X-000.99.231 ③, and belt clip ⑤. The distance ring ⑥ is part of the adaptor set.



3. Connect one end of the adaptor cord to the DELTA®20 T/DELTA®20 Plus/DELTA®20 Dermatoscope head and the other end to the BETA handle by slightly turning the head of the handle. (Put the handle into your belt clip, it will give you more freedom of movement).

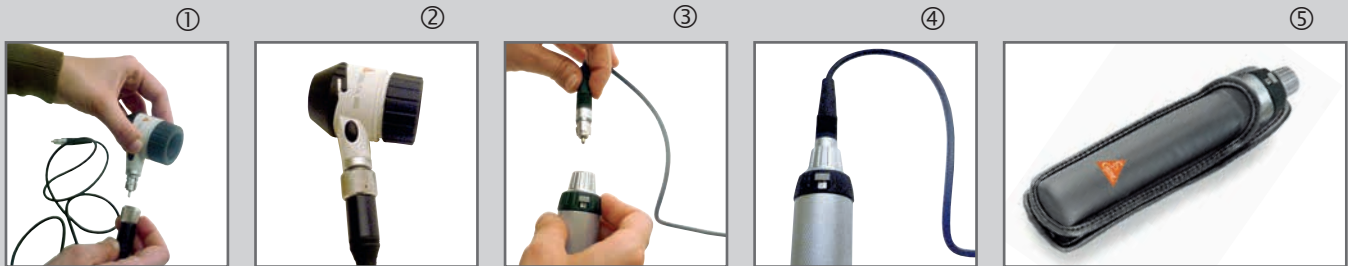

4. Connect the HEINE SLR Photo adaptor to the bayonet lock of the camera by placing the red or white spots on top of each other and twist to lock.

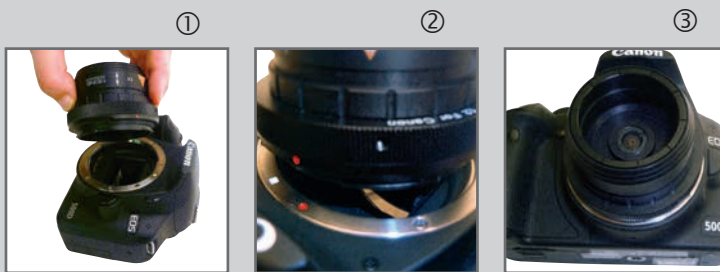

5. Connect the distance ring onto the line marked "Camera" on the focusing ring of the DELTA®20 T/DELTA®20 Plus/DELTA®20 Dermatoscope head. Once attached, tighten the focus ring down until it makes contact with the distance ring.

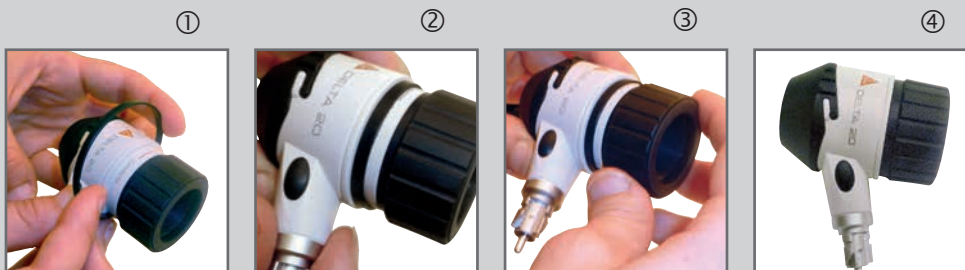

6. Connect the DELTA®20 T/DELTA®20 Plus/DELTA®20 to the SLR photo adaptor. Push the sliding ring of the adaptor with one hand down towards the camera and hold it in this position. With your free hand, insert the DELTA®20 T/DELTA®20 Plus/DELTA®20 Dermatoscope head into the adaptor until it clicks in the housing. Now release the sliding ring of the adaptor to lock the DELTA®20 T/DELTA®20 Plus/DELTA®20 onto the SLR photo adaptor. Check whether the dermatoscope can easily rotate on the adaptor and if it is locked in by gently pulling the head away from the camera body.

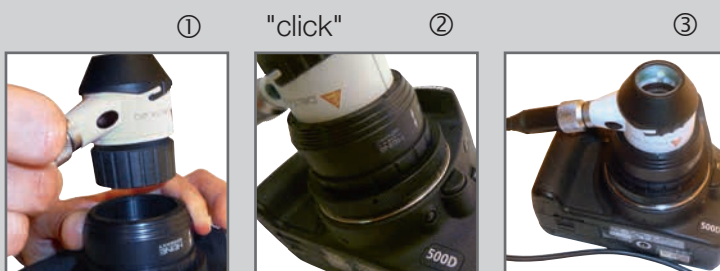

7. Adjust the settings on your camera to optimize image quality.

Following are instructions on how to make the proper adjustments for Nikon and Canon. (Please note that "auto" settings do not lead to good results.)



Example: Nikon

(pictures © Nikon)

1. Please turn the mode dial to program "M".

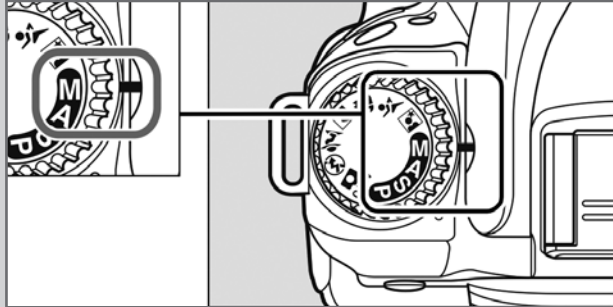

2. Set the ISO sensitivity to 400 by pressing the ISO-button while turning the rear main command dial until the correct value is displayed. The correct value appears on the bottom corner of the upper control panel.

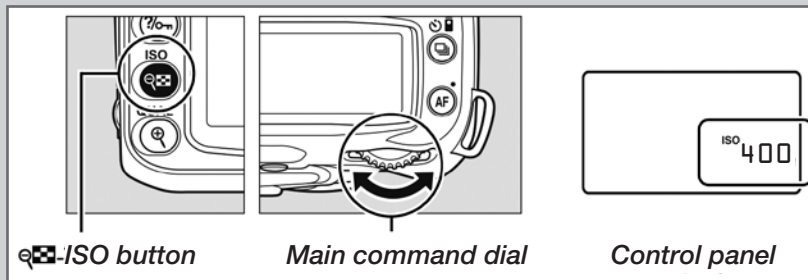

3. Set the exposure time to 1/40s. Press the shutter-release briefly until the exposure time appears on the upper control panel. Adjust the value by turning the rear main command dial.

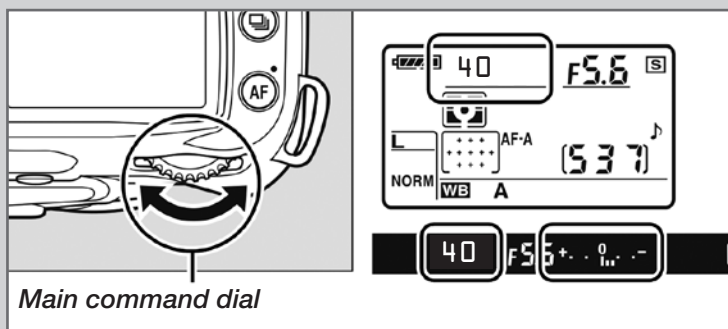

4. The white balance needs to be set once. To do this, press the WB - button and turn the rear main command dial until "PRE" is displayed on the upper control panel.

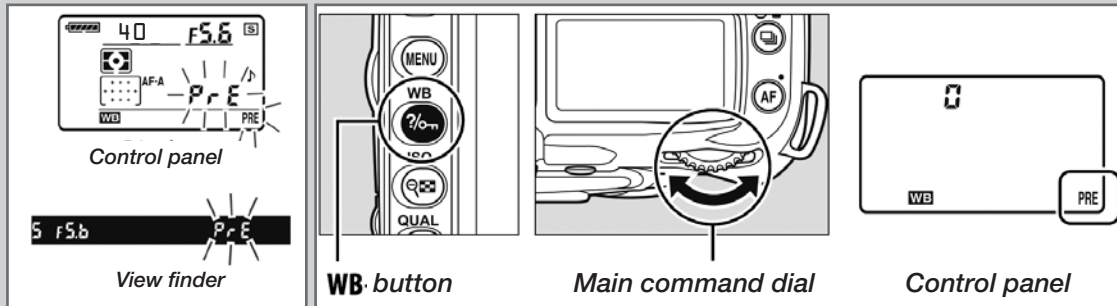

Turn the WB button until the "PRE" symbol starts to blink.

Please point the camera with the adapted DELTA®20 T/DELTA®20 Plus/DELTA20 head (switched on) on a white or neutral gray object like paper and press the shutter-release button. The display will show "good" once the measuring was accurate. In all other cases please repeat the process.

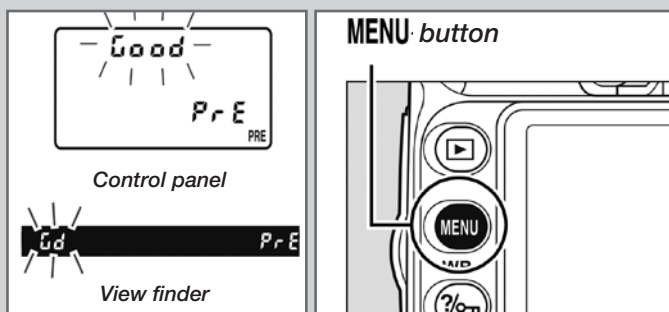

The manual white balance picture can be found in the menu. For using a previously set white balance, please also use the menu.

Please choose a white balance picture in the menu. We recommend naming the white balance picture taken with the DELTA®20 T/DELTA®20 Plus/DELTA®20 accordingly.

Example: EOS
(pictures © Canon)

1. Please turn the mode dial to the program Tv.

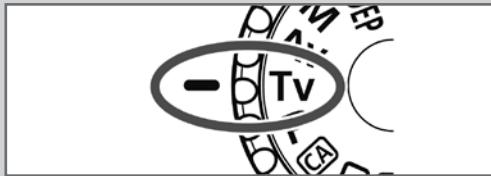

2. Set the ISO sensitivity to 400. To do so, press the ISO-button and select the value 400 on the display.

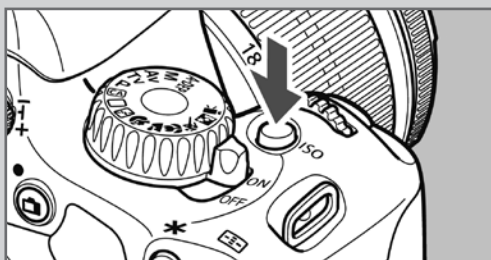

3. Adjust the exposure time to 1/40s by pushing the menu button until the following menu appears:

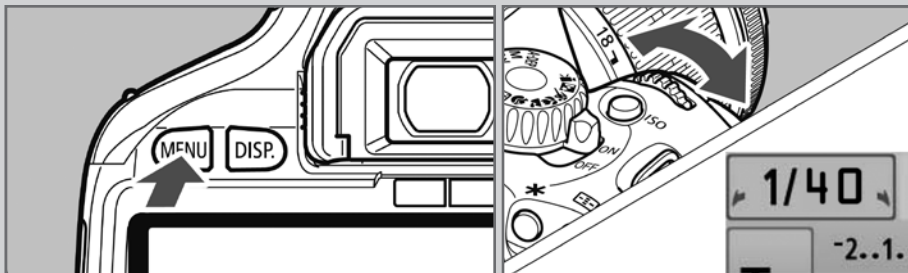

The value can be set by turning the main dial (in the front).

4. The white balance needs to be set once. To do so, please press the menu-button until the following menu is displayed:

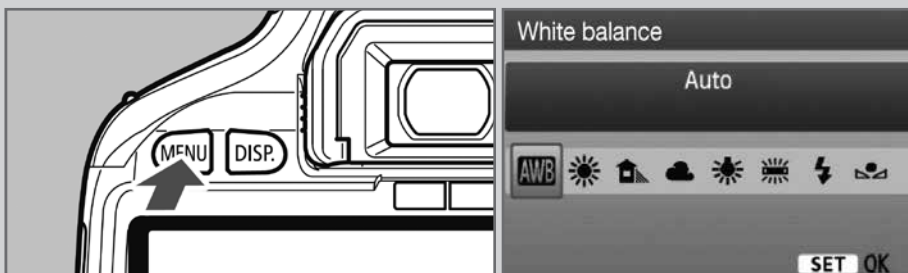

Press the WB button, select the customer white balance on the display and confirm with the "set" button.

Point the camera with the adapted DELTA®20 T/DELTA®20 Plus/DELTA®20 head (switched-on) on a white or neutral grey object like paper and press the shutter button. To accept the white balance picture, please press the menu-button until the following screen is displayed.

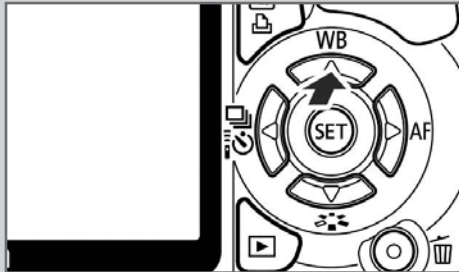

Please select the custom WB with the set-button and confirm the chosen picture with the set-button. We recommend naming the white balance picture taken with the DELTA®20 T/DELTA®20 Plus/DELTA®20 accordingly.

Canon Camera Name Chart

Europe	USA	Japan
EOS 7D Mark II	EOS 7D Mark II	EOS 7D Mark II
EOS 60D	EOS 60D	EOS 60D
EOS 80D	EOS 80D	EOS 80D
EOS 100D	Rebel SL 1	Kiss X7
EOS 700D	Rebel T5i	Kiss X7i
EOS 750D	Rebel T6i	Kiss X8i
EOS 760D	Rebel T6s	8000 D
EOS 1300D	Rebel T6	Kiss X80